

Model Name: ReX
Radio signal range extender

ReX is a range extender of communication signals that expands the radio communication range of Ajax devices fitted with a Hub up to 3-fold. It has a built-in tamper resistance and is equipped with a battery that provides up to ___ hours of operation without external power.

The device is compatible only with the Ajax hubs! Connection to uartBridge and ocBridge Plus is not provided.

IMPORTANT! This Quick Start Guide contains general information about ReX. Before using the device, we recommend that you study the User Manual on the following website:
ajax.systems/support/devices/rex

FUNCTIONAL ELEMENTS



1 - Logo with light indicator

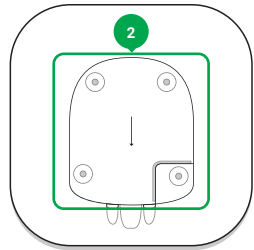

2 - SmartBracket mounting plate (perforated section is necessary to trigger the tamper during an attempt to lift ReX from the surface)

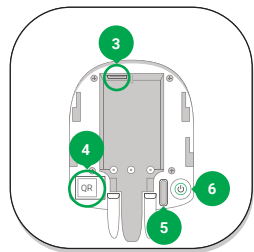

3 - Power connector
4 - QR-code
5 - Tamper button
6 - Power button

ReX expands the radio communication range of the security system allowing installation of Ajax devices at a greater distance away from the Hub.

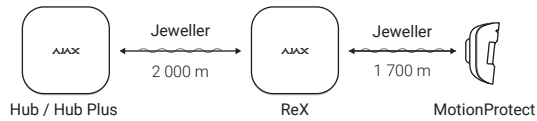

The communication range between ReX and the device is limited by the radio signal range of the device (indicated in the device specifications on the website www.ajax.systems and in the User Manual).

ReX receives Hub signals and transmits them to the devices connected to ReX and transmits signals from the devices to the Hub. The Hub polls the extender every 12-300 seconds (by default: 36 seconds) while the alarms are communicated within 0.3 seconds.

CONNECTION AND SET UP

ReX is connected to the Hub and set up via the Ajax application.

Only one ReX can be connected to the hub with Hub OS Malevich 2.7 firmware version.

1. Position the extender within the hub radio coverage area.
2. Slide the SmartBracket panel down and plug in the power cable.
3. Click **Add Device** in the Ajax application. Name the extender, scan or manually enter the QR-code (located on the lid and package), and select a room for location. Click **Add**.
4. Once the countdown begins, turn on ReX by pressing the power button for 3 seconds — the logo will change its colour from red (no communication with the hub) to white (communication with the hub has been established) within 30 seconds after ReX is switched on.

The request for connection to the hub is transmitted only when the device is turned on. If the connection to the hub fails, turn off the extender by pressing the power button for 3 seconds and retry the connection procedure after 5 seconds.

ReX connected to the hub will appear in the list of hub devices in the application. The update of device statuses in the list depends on the polling time set in the hub settings, the default value is 36 seconds.

Any Ajax device connected to the hub can be assigned to the extender regardless of the type. In order to assign ReX devices, go to the **Pair with device** menu in the ReX settings and select the required devices.

RE icon will appear in the mobile application near the devices connected through the extender:

CONNECTION AND SET UP

The number of connected devices	
Hub + ReX	Up to 99
Hub Plus + ReX	Up to 149

ReX does not increase the number of devices connected to the hub.

In the case of loss of communication with the extender, the device will try to connect to the hub.

SELECTION OF THE INSTALLATION SITE AND MOUNTING

The installation site should have reliable communication with the hub and all connected Ajax devices.

Do not place ReX:

1. Outside the room (outdoors).
2. Near metal objects and mirrors that cause attenuation or screening of a radio signal.
3. In places with high levels of radio interference.
4. In rooms characterised by humidity and temperature levels beyond the permissible limits.

Device mounting:

1. Mount the SmartBracket panel to the surface with screws or other reliable fasteners.
2. Slide the extender onto the SmartBracket mounting plate.
3. In order to ensure higher reliability, fix ReX to the plate with screws accompanying the device.

During mounting and operation of the extender, follow the general electrical safety rules when using electrical appliances as well as the requirements of electrical safety laws and regulations.

It is strictly forbidden to disassemble the device connected to the power supply and operate it with a damaged power cable!

Do not disassemble or modify ReX or its individual parts — this may interfere with the normal operation of the device or lead to its failure.

WARRANTY

Warranty for Ajax devices is valid for two years after the purchase date and does not apply to the supplied battery. If the device does not work correctly, you should first contact the support service—in half of the cases, technical issues can be solved remotely!

The full text of the warranty is available on the website: ajax.systems/warranty

User Agreement: ajax.systems/end-user-agreement

Technical support: support@ajax.systems

TECH SPECS

Maximum number of connected devices	Hub 99, Hub Plus 149
Power supply	110 – 240 V AC, 50 / 60 Hz
Back-up battery	Li-Ion 2 A×h (up to XX hours battery life)
Anti-tamper switch	Yes
Frequency band	868.0–868.6 MHz or 868.7–869.2 MHz depending on the sales region
Effective radiated power	Up to
Radio signal modulation	GFSK
Radio signal range	Up to 2000 m (any obstacles absence)
Operating humidity	Up to 75%
Operating temperature range	From 0°C to +50°C
Dimensions	162.7 x 162.7 x 35.9 mm
Weight	XXX g

COMPLETE SET

1. ReX
2. Power supply cable
3. Installation kit
4. Quick Start Guide

Manufacturer:
Research and Production Enterprise "Ajax" LLC
Address: Sklyarenko 5, Kyiv, 04073, Ukraine
By request of Ajax Systems Inc.